

M.M.

Approx TM



DIAL BEFORE  
YOU DIG  
www.1100.com.au

(W) Denotes Window

MIRIAM ST

BENCH MARK  
NAIL IN KERB  
RL 42.305 (AHD)

- NOTES 1 :-
- 1) This survey has been carried out in accordance with Clause (9) of the Surveying & Spatial Information Regulation 2017.
  - 2) Bearings, Area & Distances are by Title and / or deeds only.
  - 3) No boundary investigation has been carried out.
  - 3) Relationship of improvements to boundaries is diagrammatic only. Where offsets are critical they should be confirmed by further survey.
  - 4) Contours shown depict the topography. Except at spot levels shown they do not necessarily represent the exact level at any particular point.
  - 5) Services shown hereon have been determined from visual evidence only. Prior to any design, demolition, excavation or construction on site the relevant authority should be contacted to establish detailed location and depth.
  - 6) These notes form an integral part of this plan & should not be separated.
  - 7) Location of sewer subject to confirmation from Sydney Water or relevant authority.
  - 8) The Symbols are not to scale and are indicative only
  - 9) Tree dimensions are approximate only, shown as 15(spreadØ) 0.5 (trunkØ) & 12(height).
  - 10) Australian Height Datum (AHD) was established from PM 68093, RL 43.663.
  - Source - SCIMS Survey Mark Report.
  - 11) The Sewer Location is interpreted from Hydra & is Approximate Only.
  - 12) The bearings on these plan boundaries are from Land Titles Office plans. They are Magnetic Meridian. If accurate True North is required a further survey would be necessary.

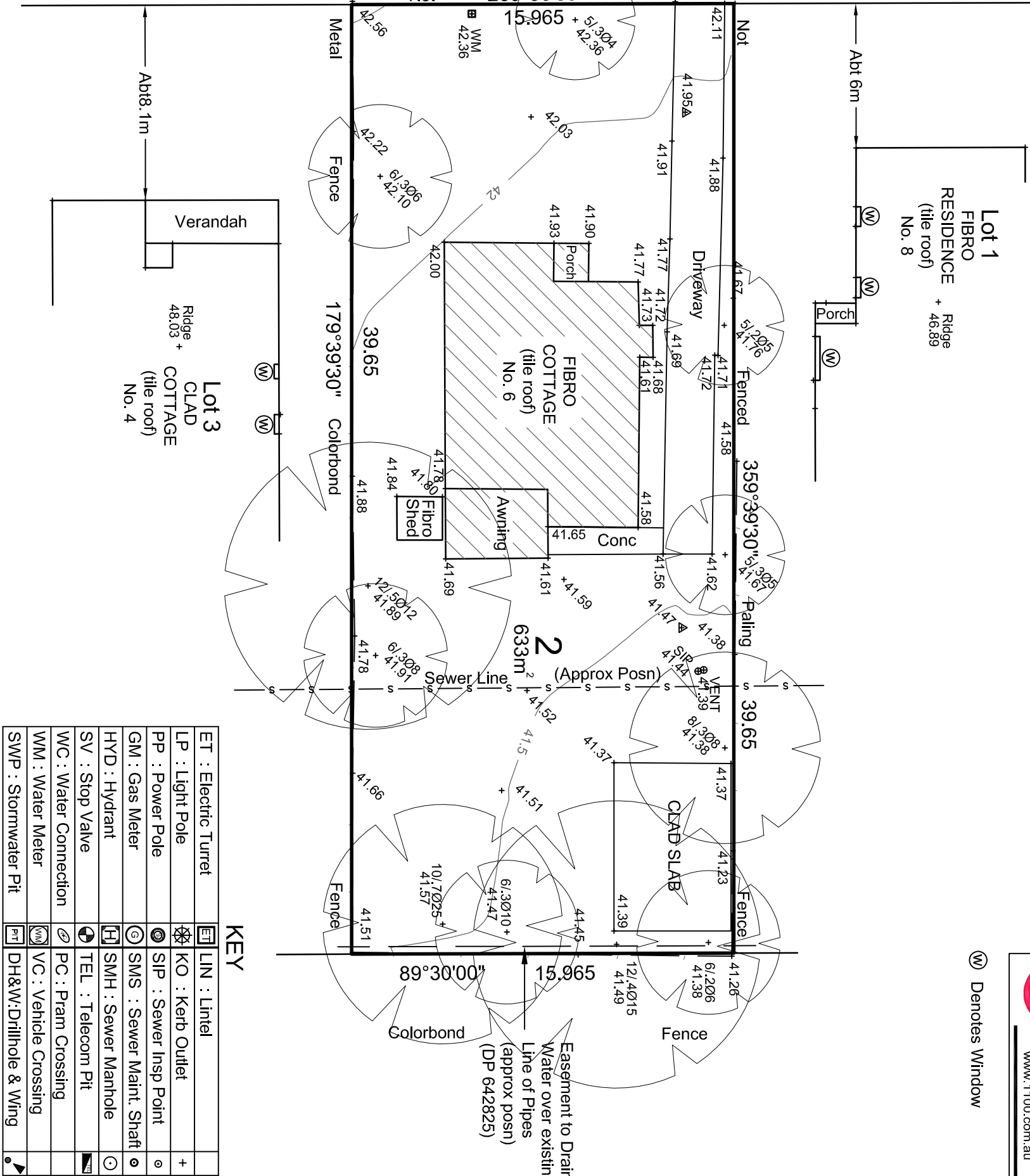

ET : Electric Turret		LIN : Lintel	
LP : Light Pole		KO : Kerb Outlet	+
PP : Power Pole		SIP : Sewer Insp Point	o
GM : Gas Meter		SMS : Sewer Maint. Shaft	o
HYD : Hydrant		SMH : Sewer Manhole	o
SV : Stop Valve		TEL : Telecom Pit	
WC : Water Connection		PC : Pram Crossing	
WM : Water Meter		VC : Vehicle Crossing	
SWP : Stormwater Pit		DH&W: Drillhole & Wing	

All Correspondence to:

343 Hume Highway, Liverpool, N.S.W. 2170  
P.O.Box 242 Liverpool, N.S.W. 1871  
Tel: (02) 9602-1199 Fax: (02) 9621-2620  
Email: survey@burtonandfield.com.au

Suite 202, 2 Pembroke Street Epping, N.S.W. 2121  
P.O.Box 1150, Epping, N.S.W. 1710  
Tel: (02) 9868-4660 Fax: (02) 9868-6035  
E-mail: epping.reception@burtonandfield.com.au  
Web: www.burtonandfield.com.au

PROJECT:

CONTOUR & DETAIL SURVEY FOR  
LOT 2 IN DP 35353  
6 MIRIAM ST., BASS HILL

LGA: CANTERBURY ~ BANKSTOWN

COMP REF: J:\83471\...\83471\_C\_ Your Ref 4923

REVISION

CLIENT: ALLCASTLE HOMES P/L

DATE: 01/10/2021 SCALE: 1:200 SHEET

REF: 34093/83471/1/JMK DATUM: AHD 1 of 1



BURTON & FIELD  
surveying & land development

CAUTION 1 :  
INFORMATION CONTAINED IN THIS PLAN IS THE  
COPYRIGHT OF BURTON AND FIELD PTY LIMITED.  
THE USE, DUPLICATION (WHETHER IN PART OR FULL)  
WITHOUT CONSENT OF BURTON AND FIELD PTY LIMITED  
CONSTITUTES AN INFRINGEMENT OF COPYRIGHT.